

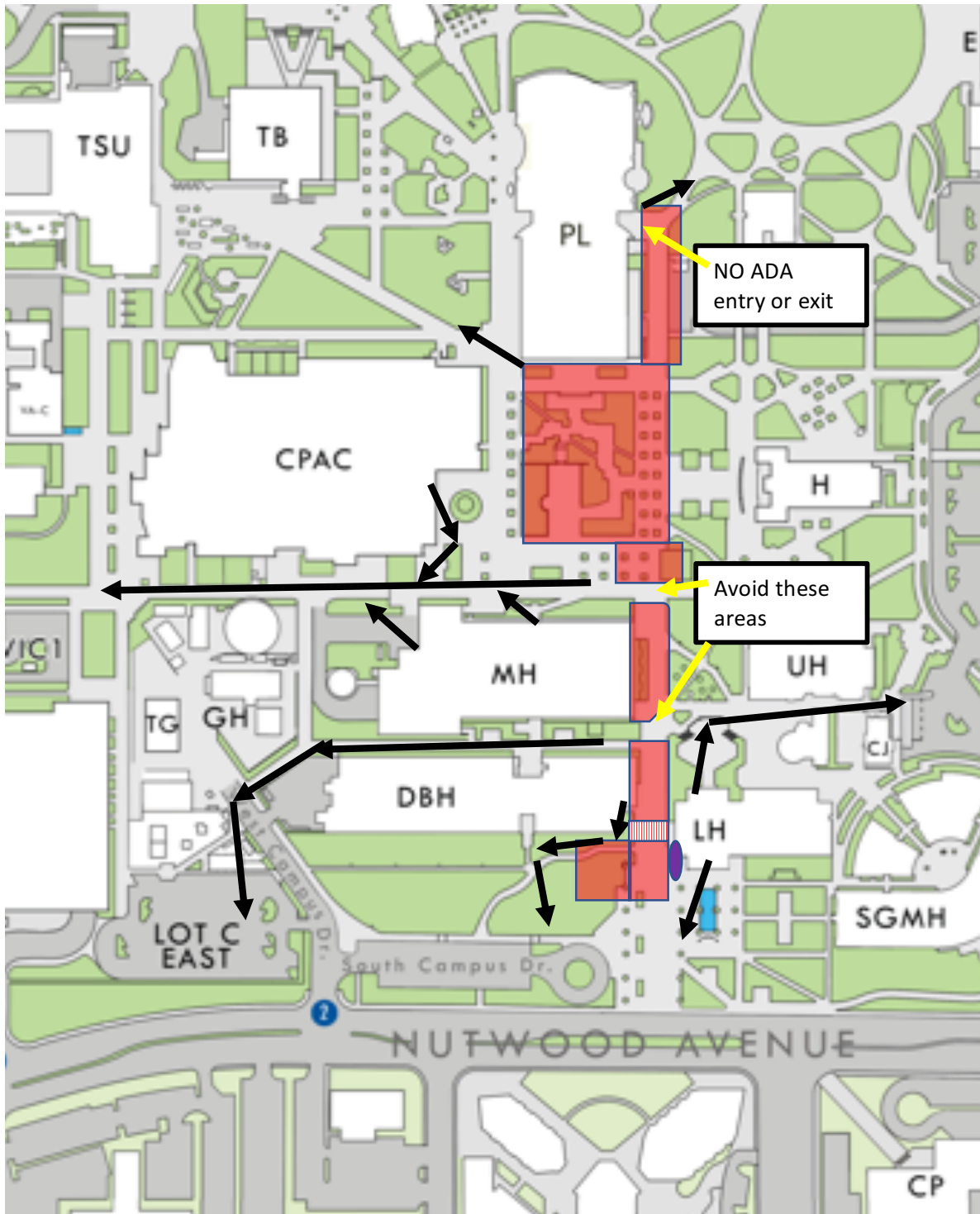



Move at least 50 feet away from any building.

19

CAMPUS EVACUATION MAP, page 2
Alternation of Evacuation Routes during Titan Walk Project
Sue Fisher, Emergency Management Coordinator



Blocked Off Areas  **This exit closed (LH):**  **EXIT ONLY (LH):** 

Altered Evacuation Routes  **Note areas to avoid to reduce congestion/blockage.**
SEE NOTES BELOW:

NOTES**1. AVOID THE PASS-THROUGHS....East side (and north and south ends) of MH.**

Try to keep people from using the pass-throughs from one side of the project to the other. These areas are relatively narrow and can cause severe congestion and a dangerous situation if lots of people try to pass through them at once.

2. AVOID EAST SIDE OF MCCARTHY HALL.

You CAN exit the building on the east side of MH, but try not to. People will be forced to go either north toward the Quad, or south where there is a narrow walkway along the south of the building.

Large numbers of people will not exit very well or very quickly on this side, so direct them to the west and center MH stairwells, if possible, then head them west (AWAY from the construction area).

3. DBH EAST EXITS ARE RE-DIRECTED.

You CAN exit on the east side of DBH, but you are directed immediately south and around to the Nutwood wide of DBH. DBH and MH – note the west LH exit below (6).

4. ALL OTHER BUILDINGS—especially UH, HUM & CPAC: Avoid the Project Area!

Direct people away from the buildings, but also AWAY from the Project area so no one has to cross over it to evacuate a building.

5. UPPER PART BY LIBRARY

The east exit from the Library (by Starbucks) is NOT ADA accessible during construction. Use the west exit from the Library if you cannot walk up or down stairs.

6. LANGSDORF HALL HAS OPENED THE WEST SIDE STAIRWELL EXIT.

The western stairs exit in LH has now been opened. Note that this is an EXIT ONLY from the ground level and you cannot enter the building through this door. So, do not enter this passthrough from DBH.

7. Please let me know if you have any concerns.

Sue Fisher, sfisher@fullerton.edu, (657) 278-3572.